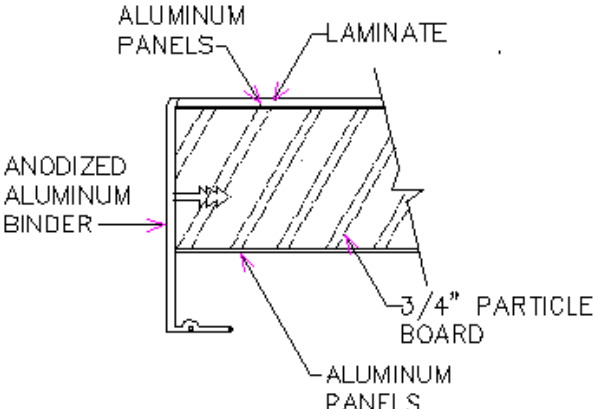

Counter Specifications	Customer Benefit
<p><u>Counter Load Specifications</u></p> <ul style="list-style-type: none"> Counter Tops to support 60-pounds/square foot static load with maximum deflection of 1/8". Standard interior shelves to support 25-pounds/square foot static load with maximum deflection of 1/8". Cigarette shelves to support 10 pounds/square foot with maximum deflection of 1/8". 	<p>Royston's design ensures your counters are built to support the loads you can expect in the most demanding real-world conditions.</p>
<p><u>Metal Cabinet Components</u></p> <p>All of the following are made from Cold Rolled Steel; gauges are chosen to provide strength as appropriate for each component:</p> <ul style="list-style-type: none"> Leg Supports 13 Gauge Horizontal Rails 14 Gauge Bottom & Adjustable Shelves 21 Gauge Shelf Stiffeners 22 Gauge Vertical Rails 22 Gauge Cabinet Panels 22 Gauge Panel Stiffeners 22 Gauge Doors & Stiffeners 18 Gauge Drawer Front 21 Gauge Drawer Body 21 Gauge Drawer Track 18 Gauge Bases 16 Gauge 	<p>All steel construction; engineered for strength and durability. The Royston counter is designed to be tough and look great for many years to come. We know of many cases where counters we made are in service for over 15 years and still look good and are serviceable after heavy use in a very harsh environment. Peace of mind after the purchase is one of the many reasons to choose Royston.</p> <p>Heavier gauges are used where components carry the load. The Royston design optimizes strength while keeping down the cost.</p>
<p><u>Cabinet Construction Specifications</u></p>	
<ul style="list-style-type: none"> <u>Doors and Hinges</u> –Door Hinges are Pivot Type of 12 Ga. Stainless Steel and conform to NSF requirements. Doors and cabinets do not fail or show permanent deflection when tested to 150# static load on an open door. All doors include a magnetic catch. 	<p>Pivot hinges provide strength, durability, and minimum need for adjustment. They are stainless steel to ensure that corrosion is never a problem where they will be exposed to moisture over a period of many years. Doors can be removed without tools for cleaning, per NSF requirements, and open a full 175°.</p>

Counter Specifications	Customer Benefit
<ul style="list-style-type: none"> ▪ <u>Interior Upright System</u> – Royston counters feature an interior upright system that permits the easy addition of modular accessories, such as adjustable shelves, drawers, cigarette drawers, pull-out bins, and others. 	<p>This feature provides great flexibility to add a variety of options at any time.</p>
<ul style="list-style-type: none"> ▪ <u>Adjustable Shelves</u> - Standard on most styles of counters (wherever appropriate), and include a 1” chase area between the back of the shelf and cabinet back panel. A 15/16” lip at the back edge of the shelf is provided to keep material from falling off the back of the shelf. 	<p>Built-in capability to adjust the cabinet storage configuration to your needs using the Royston interior upright system. Shelves can be reversed to provide a tilted shelf with the 15/16” lip at the front.</p>
<ul style="list-style-type: none"> ▪ <u>Chase Area</u> – All wall-mounted cabinets provide a minimum 6” chase area between the cabinet and wall. A 10” high opening in the cabinet back is provided for access into the chase area. This opening is the width of the cabinet minus 3” on each side. An optional close-off panel is available where needed to meet local health code requirements. 	<p>This opening is designed for easy access behind the counter for access to plumbing and electrical connections. It is sized for maximum space, while maintaining the strength of the cabinet. It is positioned at the correct height for standard electrical and plumbing wall connections.</p>
<ul style="list-style-type: none"> ▪ <u>Removable Bottom Panel</u> – All Royston counters feature a removable, or “loose”, bottom panel to provide access underneath the counter. No tools are required to lift this out. 	<p>For the initial installation, permits easy access to the leveling legs built into every base. For the life of the counter, this feature provides easy access for cleaning and to electrical and plumbing lines that run through knockouts or are located beneath the cabinet.</p>
<ul style="list-style-type: none"> ▪ <u>Knockouts</u> – All Royston counters include knockouts in the Cabinet to provide access between counters for electrical and/or plumbing lines. Standard are two 2” X 3” Obround knockouts in the upper rear corner of the cabinet body – one each side. 	<p>These handy knockouts provide the option to easily route utilities between counters in a line-up. They are positioned for maximum utility.</p>
<ul style="list-style-type: none"> ▪ <u>Stainless Guides for Waste Cans</u> – Waste counters include a stainless steel guide track attached to the removable bottom panel. 	<p>The stainless guide keeps the waste can centered under the angled chute. It is stainless steel to resist wear from repeated friction from waste can removal. It can be easily removed without tools for cleaning.</p>

Counter Specifications	Customer Benefit
<ul style="list-style-type: none"> ▪ <u>Chute built in to direct trash into waste can.</u> 	<p>Helps eliminate a messy situation inside the waste counter by directing the trash into the can.</p>
<ul style="list-style-type: none"> ▪ <u>Rugged Waste Can</u> – provided with every waste counter. 	<p>Designed for durability and ease of cleaning.</p>
<ul style="list-style-type: none"> ▪ <u>Polycarbonate Cup Cover</u> – Standard detail on all beverage counters includes a clear cup cover. An optional design calls for the countertop to extend over this area. 	<p>Maintain visibility of cups, while protecting them from spills. Snaps off for easy removal for cleaning. Manufactured from polycarbonate for strength and durability.</p>
<ul style="list-style-type: none"> ▪ <u>Acrylic Condiment Tray</u> – Royston condiment trays are manufactured in house with adjustable PETG dividers. 	<p>Permits easy organization of lids, straw, and condiments. Entire assembly is easily removed for cleaning.</p>
<ul style="list-style-type: none"> ▪ <u>Cup dispensers</u> – Royston features its own patented cup dispensers in all cup counters and towers. 	<p>Royston cup dispensers are an industry standard, known for durability and ease of use. The CD-170 cup dispensers are fully adjustable for all cups from 8-44 oz. (up to 4.5" diameter) without tools or adapters, and are available with a choice of attractive trim ring colors (gray, blue, black, or red). A Jumbo cup dispenser (CD-172) is available for cups from 44-64 oz. (4.5" – 5" diameter). They reliably dispense one cup at a time.</p>
<p>Cabinet Foundation Counters rest on 6.25" bases unless otherwise specified. A 1.125" toe-space is provided front and back. An opening is provided in the base assembly to run plumbing and conduit between cabinets. Legs are available where required to meet local health codes, as is an optional removable kickplate.</p>	<p>Different options to meet your needs. The Royston base includes adjustable leveling legs in each corner, with easy access via the removable bottom panel. 4.25" and 10.25" high bases are also available.</p>

Counter Specifications	Customer Benefit
<p>Counter Height Standard countertop heights are: 24.5", 27", 31.5", 33.5", 36", 40" and 42" above finished floor with the levelers all of the way in (the lowest position). Refer to Royston's Product Configuration Guide for the available features for different height cabinets.</p>	<p>Permits leveling of counters (33.5") to uneven floors while remaining within ADA guidelines, as described below.</p> <p>ADA 902.3 Height. The tops of work surfaces shall be 28 inches minimum and 34 inches maximum above the finish floor or ground.</p>
<p>Finish (Powder Paint) Electro-statically applied Hybrid Powder.</p> <ul style="list-style-type: none"> • Average Mill thickness 1.5 – 4 mil. • Baked on at 365° Typical. • Gloss 40-50°. • Pencil hardness H-2H. • Direct/Indirect 160/140 inch/lbs. @ 1 mil. • Cross Hatch – 0% removal. • Salt spray .032 C.R.S. substrate hours-1000 • Creep from scribe-zero removal. <p>All tests evaluated per ASTM Standards.</p> <p>Certain colors are provided using a high quality baked enamel.</p>	<p>Provides a state-of-the-art metal finish. In addition to tremendous durability it permits Royston to provide special finishes with textures and multiple colors.</p> <p>The powder is actually fused to the metal during the baking process. Powder coating is an environmentally friendly process.</p> <p>Iron phosphate pre-treatment is standard for all Royston cabinets; it is used for both corrosion resistance and finish adhesion.</p>
<p>Hardware Fasteners are steel with Zinc Plating or better.</p>	<p>Provides strength, durability, and corrosion resistance.</p>

Counter Specifications	Customer Benefit
<h2>Counter Top Construction</h2>	
<p>The top is an integral part of a Royston counter. The top makes the counter complete and functional – in fact, the top selection is really the key to making it do what you need it to do. Royston builds its tops in-house. What’s more, they are all designed specifically for use in convenience stores, so they will stand up to the harsh environment.</p>	<p>Genuine Royston tops are renowned for their durability and good looks. We offer several options in size and material, and all except Stainless Steel have numerous color options as well– one of these is sure to be right for your store.</p>
<h2>Laminate Tops</h2> <h3>Design and Construction</h3> <p>There are several things that make the Royston Laminate Top the best laminate top:</p> <ul style="list-style-type: none"> • The substrate of a Royston Laminate Top is ¾” thick particleboard, which provides the strength to support countertop equipment. • Aluminum panels (.016” thick) are bonded to both sides of the particleboard to provide an effective moisture seal and additional strength. • The laminate cover is then bonded over one side of the particle board/aluminum substrate “sandwich”. • An anodized aluminum edge binder is added to greatly reduce the possibility of edge chipping. • Add-on painted metal backsplashes (4” high) are available. 	<h3>Choose Royston Laminate Tops for:</h3> <ul style="list-style-type: none"> • Adding a variety of colors and patterns to a counter top. • Use in Sales Counters, where extreme moisture is not an issue. • Generally the lowest cost top alternative. • An extremely well constructed, durable laminate top. 

Counter Specifications
Customer Benefit

Stainless Steel Tops

Design and Construction

There are several things that make the Royston Stainless Steel Top the best stainless steel top:

- The substrate of a Royston Stainless Steel Top is $\frac{3}{4}$ " thick particleboard, which provides the strength to support countertop equipment.
- An aluminum panel (.016" thick) is bonded to one side of the particleboard to provide an effective moisture seal and additional strength.
- The stainless steel cover (20 gauge) is then bonded over the other side of the particle board/aluminum substrate "sandwich".
- A combination of stainless steel, aluminum, and silicone completely seal this top from moisture and vermin.
- Available with or without integral backsplashes (4" high). Add-on backsplashes (also 4" high) are also available.

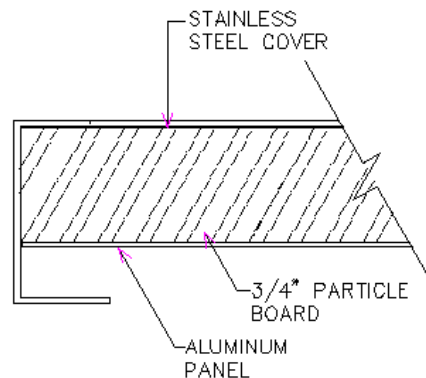

Choose Royston Stainless Steel Tops for:

- The ultimate in strength and worry free durability.
- Wet (fountain, coffee, etc.) applications in addition to sales counters.
- Food prep areas where maintaining sanitary conditions is essential.
- A high value, moderate cost.

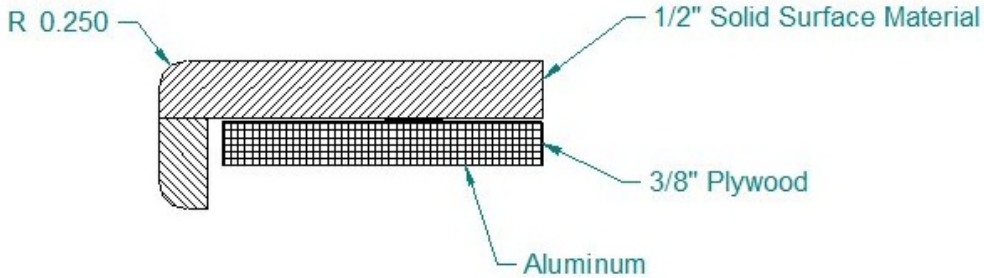
Counter Specifications	Customer Benefit
<p>Solid Surface Tops</p> <p>Design and Construction</p> <p>There are several things that make the Royston Solid Surface Tops the best solid surface top:</p> <ul style="list-style-type: none"> • The substrate of a Royston Solid Surface Top is 3/8" thick plywood. Available top support kits provide the strength to support almost any countertop equipment. • An aluminum panel (.016" thick) is bonded to the bottom side of the plywood to provide an effective moisture seal and additional strength. • The solid surface material cover (1/2" thick) is then bonded to the substrate using silicone adhesive. • A matte finish is provided for the solid surface material to minimize the effect of minor scratches. • Available with add-on (4" high) backsplashes. 	<p>Choose Royston Solid Surface Tops for:</p> <ul style="list-style-type: none"> • The ultimate in upscale, high image counters. • Numerous available colors and patterns. • A seamless countertop. • Suitable for all areas of the store. • The ability to repair or refinish countertops should they become scratched or damaged. They can be made to look new again. • Material is NSF approved. • Your guarantee of superior performance in a solid surface top. <p>Royston works with all the major brands of solid surface material, including Avonite, DuPont Corian, Wilsonart Gibraltar, and Formica Surell.</p>

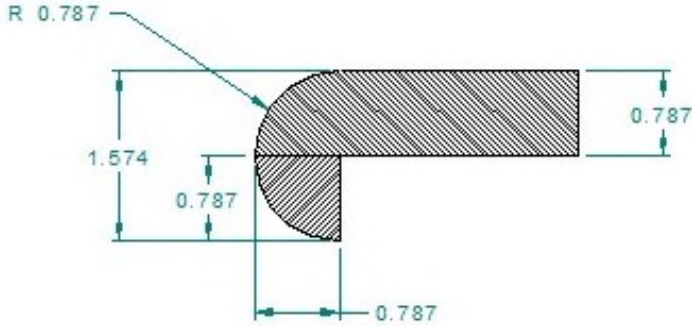
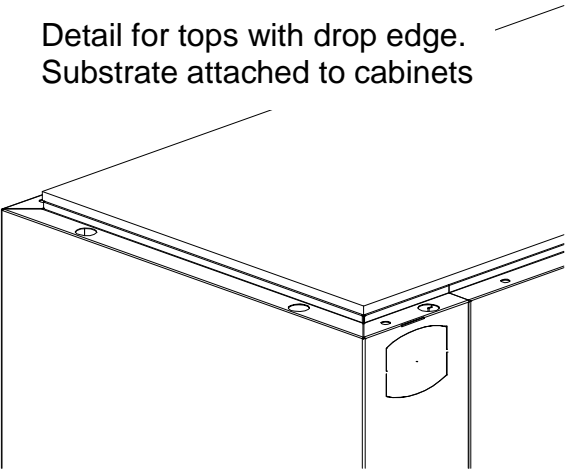
Counter Specifications	Customer Benefit
<h2 data-bbox="178 277 772 329">Engineered Stone Tops</h2> <p data-bbox="178 334 558 367">Design and Construction</p> <p data-bbox="275 371 1209 440">There are several things that make the Royston Engineered Stone Top the best stone top:</p> <ul data-bbox="323 448 1192 667" style="list-style-type: none"> • The substrate of a Royston Engineered Stone Top is 3/8" thick plywood. Available top support kits provide the strength to support almost any countertop equipment. • The engineered stone material cover (2cm or 3cm thick) is then bonded to the substrate using silicone adhesive. • Available with add-on (4" high) backsplashes. <div data-bbox="184 786 871 1109">  <p data-bbox="934 846 1150 914">2 cm thick Drop Edge Top</p> </div>	<p data-bbox="1247 272 1829 305">Choose Royston Engineered Tops for:</p> <ul data-bbox="1247 313 1938 537" style="list-style-type: none"> • The ultimate in upscale, high image counters. • Numerous available colors and patterns. • Suitable for all areas of the store. • Material is NSF approved. • Your guarantee of superior performance in an engineered stone top. <p data-bbox="1247 542 1892 646">Royston works with Caesarstone, LG Viatera, Silestone and other manufacturers of quality engineered stone material.</p> <div data-bbox="1318 873 1881 1341"> <p data-bbox="1356 889 1787 959">Detail for tops with drop edge. Substrate attached to cabinets</p>  </div>

Top Material Options – Feature Comparison

	Laminate	Stainless Steel	Solid Surface	Engineered Stone
Suitable for "wet" areas	Not Recommended	Y	Y	Y
Suitable for Food Prep areas	Not Recommended	Y	Y	Y
Suitable for Sales Transaction areas	Y	Y	Y	Y
Seamless construction	up to 96"	up to 96"	entire counter if desired	up to 96"
Repairable if damaged	Replace Top	Replace Top	Yes	Replace Top
Backsplash	Add-on Painted Metal	Integral or Add-on	Add-on	Add-on
Colors/Patterns available	Yes	No	Yes	Yes
Relative Cost	Lowest	Moderate	Highest	Highest